

01 Alignment
Minimizing building footprint to reduce impact on site whilst also respecting the facade of the heritage form (make 2d like previous step)

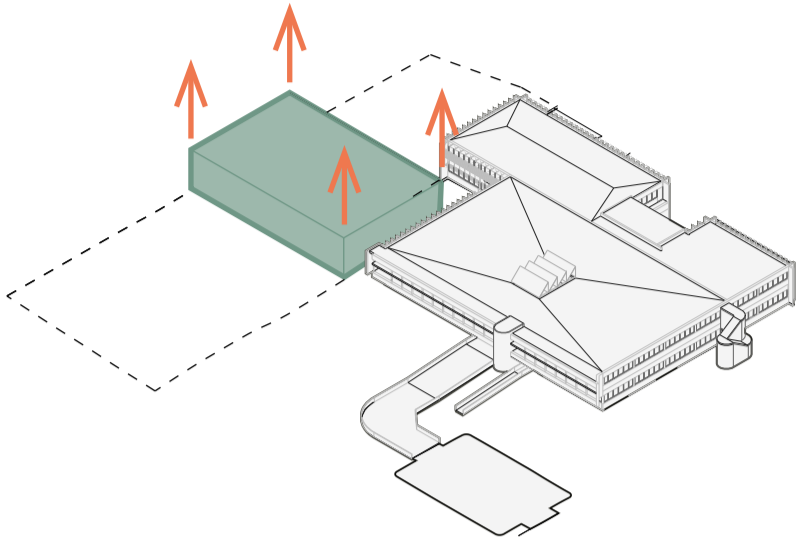

02 Pedestal
Raising the building to match rigidity and form of heritage building ensure continuity and cohesion.

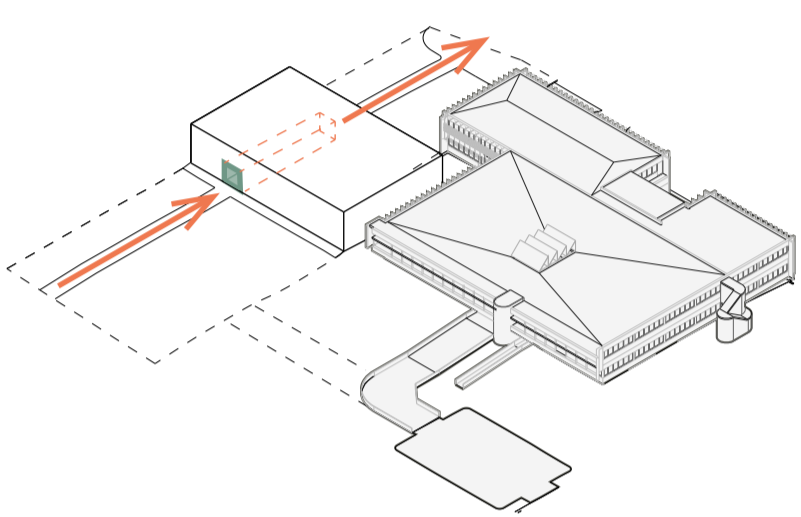

03 Thoroughfare
The design connects St Albans road with future residential zone whilst dividing the main mass into 2 areas for clearer defined programs

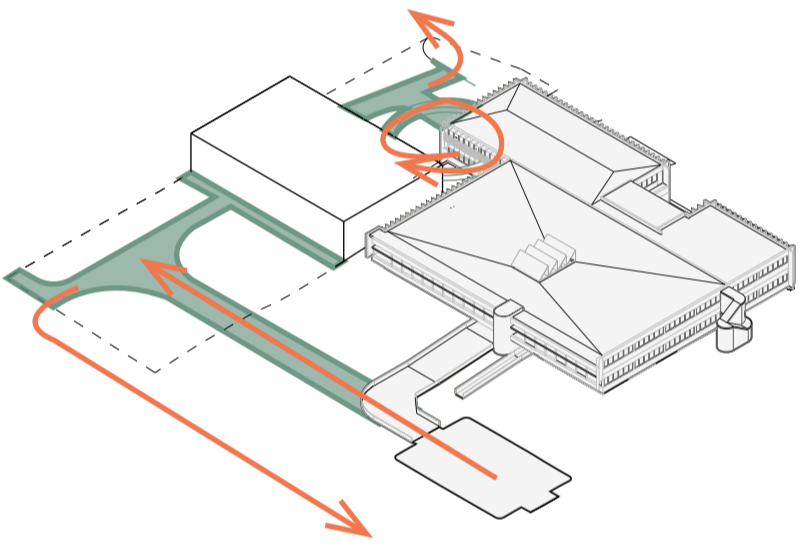

04 Connection
Connection between heritage and surrounding urban context allows an integrated fabric of architecture and community.

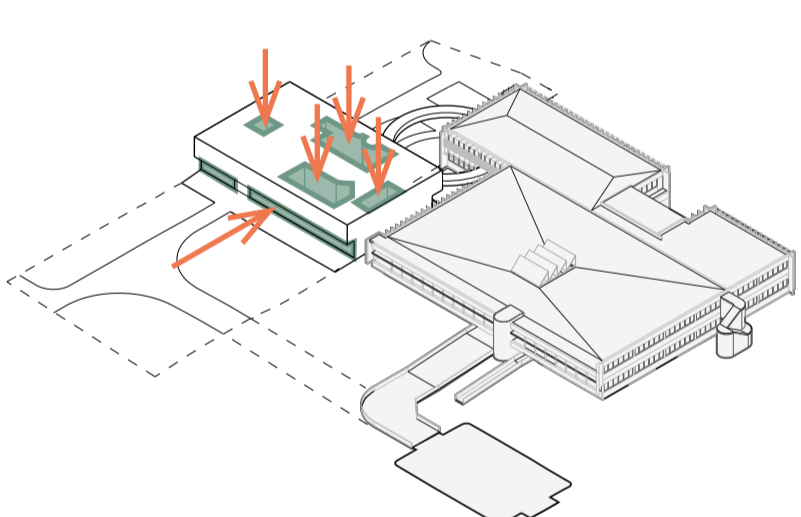

05 Protrusion
Detailing inspired by the heritage front facade whilst framing views towards future development and providing light wells

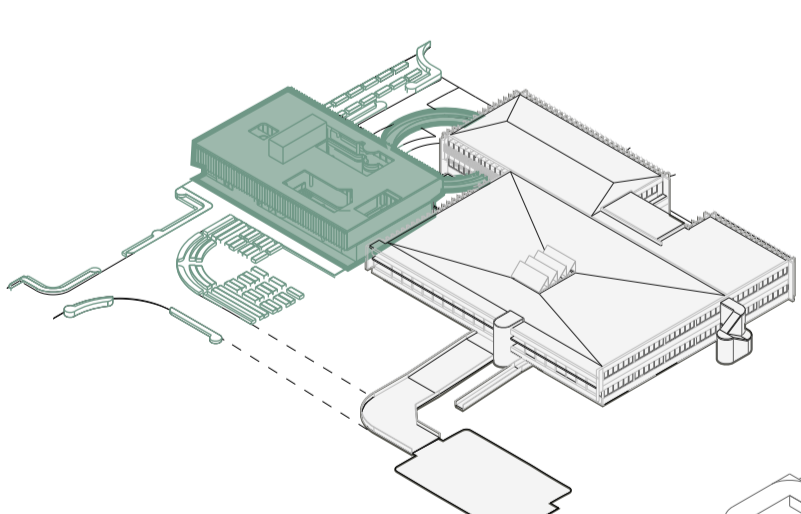

06 Refinement
Detailing to landscaping, facade and floor plan.

